



eve aqua

Reviewers Guide



eve.

Eve Aqua - Smart Water Controller

Eve Aqua converts your outdoor faucet into an intelligent water outlet. So you can keep your garden green with little to zero effort. Activate your sprinkler via your iPhone, Siri, or the onboard button, and let it shut off automatically.

Set schedules to automate your irrigation system. Plus see how much water you're using.

Eve Aqua leverages the power of HomeKit and connects directly to your iPhone or iPad using Bluetooth low energy technology. Which ensures a simple setup and eliminates the need for a bridge.



Eve Aqua - Highlights

1. Control with a touch or your voice

Sure, you can water with a touch of the integrated button. But it's all the more satisfying to control Eve Aqua with your iPhone, iPad, Apple Watch, and even Siri voice commands.

4. Water while you're away

On vacation and expecting a heatwave back home? No problem. With your home hub keeping you connected to your abode, you water your yard as if you're right there.

2. Cap your tap

Eve Aqua automatically shuts off at the perfect time, every time. Simply set your watering duration once, and never watch the clock – or flood your garden – again.

5. Irrigate with insight

How much H2O does your garden consume? The Eve app calculates usage over time, so you'll know.

3. Automate with schedules

Sunrise may be best for watering, but not waking. So just set a schedule, sleep in, and let Eve Aqua do it for you.

6. Leave it to its own devices

Eve Aqua is built to live autonomously. IPX4 water resistance plus Australian-certified UV protection keeps it shipshape season after season. Schedules work independently of any wireless connection.

Eve Aqua Hardware

Shuts off automatically after
user-defined duration

Onboard button for manual
control

Child lock prevents
unwanted watering



Connects to a standard,
3/4 inch faucet; Pressure:
min. 1 bar / max. 5 bar

Elegant casing
with UV protection
and IPX4 water
resistance

Works with standard,
3/4 inch gardening
equipment

Connecting Eve Aqua

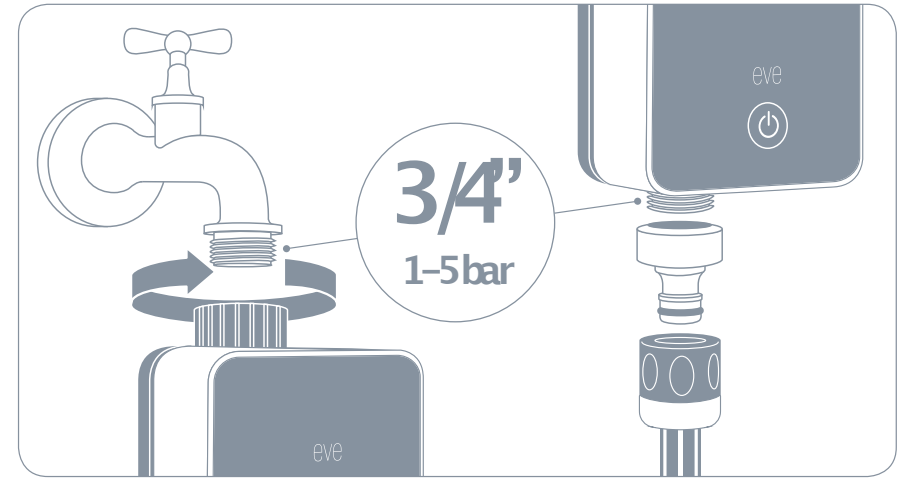
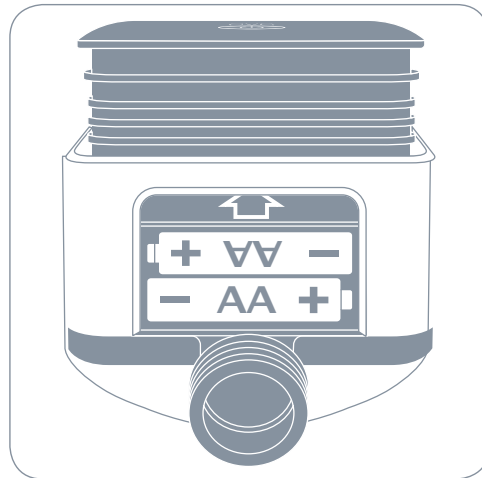
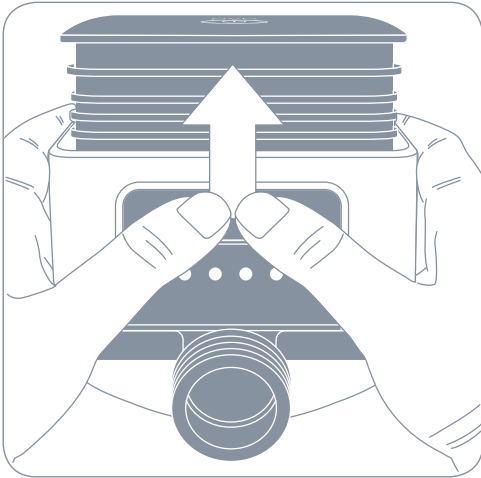

1. Before installation, you need to insert the included AA batteries. Turn Eve Aqua around and use your thumbs to slide the battery compartment cover away from you, in the direction of the arrow. Insert the batteries. Then slide the cover back until it closes with an audible click.
2. Open the Eve app and tap Add Accessory. Eve will now guide you through the setup process.
3. Mount Eve Aqua on your faucet and connect a hose. Attach the tap adapter if your irrigation system uses quick coupling valves.
4. Test Eve Aqua. Open your faucet and press the onboard button to start and stop watering.

Using Eve Aqua with Eve and Apple Home

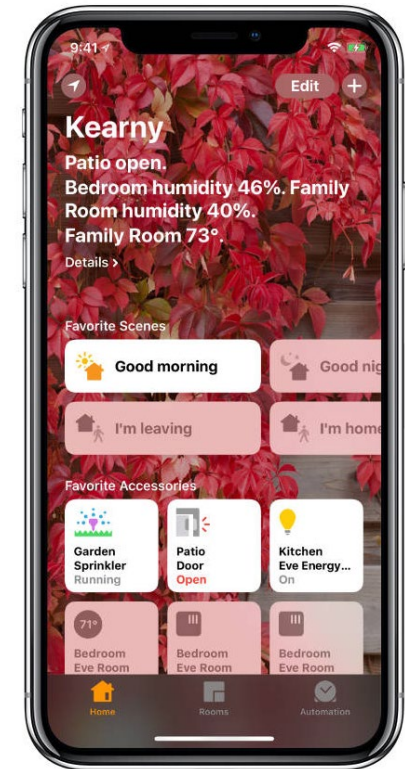
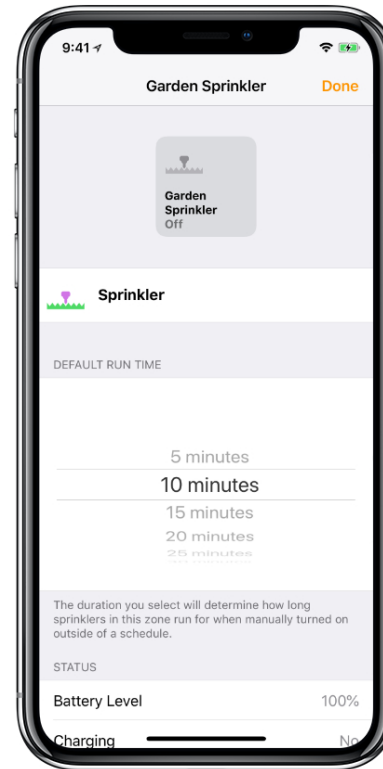
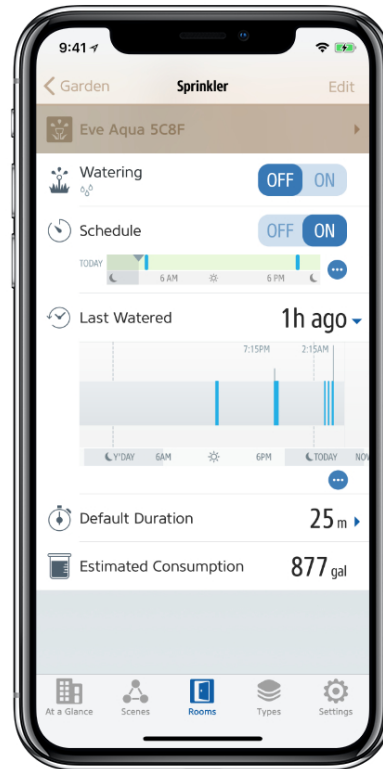
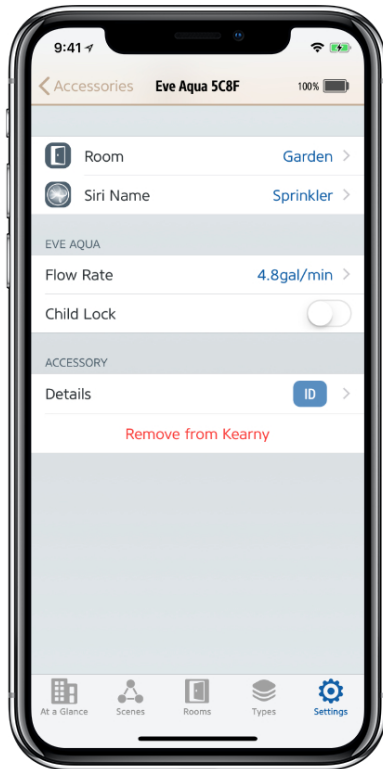

Eve...

- ... lets you set up schedules
- ... estimates your water consumption
- ... enables an optional child lock
- ... remembers when you last watered

Apple Home...

- ... gives you at-a-glance irrigation status info in your phone's lock screen
- ... quickly lets you set the default run time
- ... enables watering via a Siri command and/or your Apple Watch

Using schedules and HomeKit automations

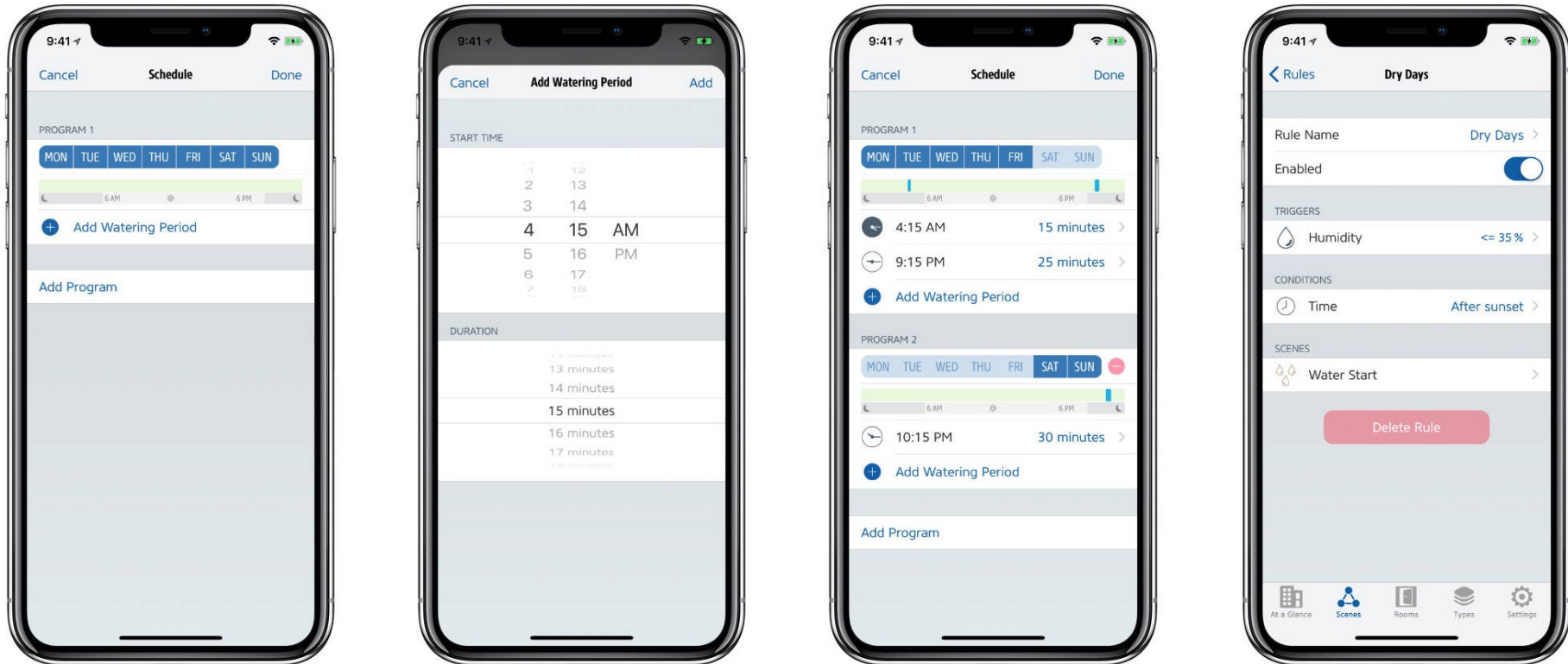

Use the Eve App to program Eve Aqua to water your lawn automatically at specific times. These schedules are stored on the device, and work independently of any wireless connection. You may create and run multiple schedules simultaneously to water at weekday- and weekend-specific times. Determine the flow rate of your irrigation system by looking it up in your sprinkler's documentation, or by using a measuring bucket to collect a minute's worth of water from each outlet

in your system, including, for example, drip valves and irrigation heads. Add up all measurements and enter the final value in the Eve app to enable consumption calculation. Use HomeKit-enabled sensors to create rules in Eve which activate Eve Aqua based on outside air temperature or humidity. Apple Home currently doesn't support creating automations that include irrigation systems like Eve Aqua.

FAQ

Will Eve Aqua connect to my GARDENA system?

Standard threads on both connectors, a hose adapter, and a pressure range of Min 1 bar / Max 5 bar ensure compatibility with any common irrigation equipment.

Is it safe to leave Eve Aqua connected all year round?

While Eve Aqua is weatherproof and UV resistant, you should prevent it from freezing up, just like your hoses and sprinklers.

How do I determine my system's flow rate?

Using a water flow meter (starting at USD \$20) is the most convenient way. Alternatively, use a measuring bucket to collect a minute's worth of water from each outlet in your system.

Is it possible to automate Eve Aqua according to a weather forecast?

No. Eve products rely exclusively on HomeKit and therefore can't be hooked up to third-party cloud services like IFTTT.

Is it possible to integrate Eve Aqua with a soil moisture sensor?

At this point, HomeKit-enabled soil moisture sensors have yet to be announced (more info: <https://www.apple.com/ios/home/accessories/>).

My yard is out of range

Once set up, Eve Aqua can run schedules fully autonomously. A home hub is only required for remote access and HomeKit automations.

eve.

For further questions please contact Jen Squilla,
+1 305 374 4404 Ext.191, jensquilla@maxborgesagency.com